

S:\Projects\APL\HCAA\CA Master Plan Update\HCAA digital files\HCAA CA Base files\AUP_SalesPCOL_03_AUP.dwg Modified: Aug 07, 2017 - 11:00am Plotted: Aug 08, 2017 - 9:54am bob.norris

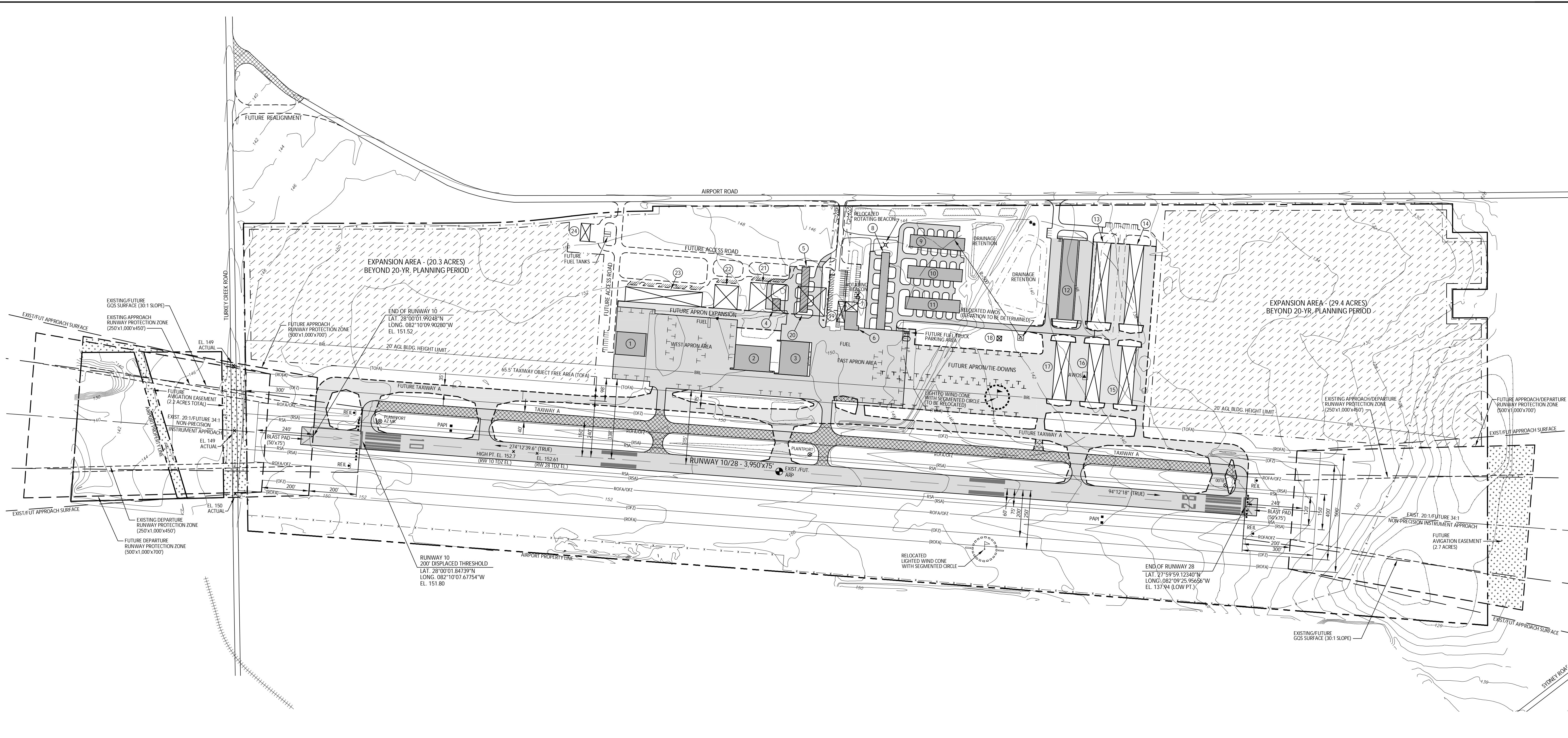

BUILDING/TENANT INDEX			
NO.	BLDG. I.D. NO.	DESCRIPTION	ELEVATION (FT.) MSL (ESTIMATED)
1	5000	BULK HANGAR	177.00
2	5000	BULK HANGAR	168.98
3	5000	FBO MAINTENANCE HANGAR/BULK HANGAR	162.50
4	4800	OPERATIONS AND MAINTENANCE SHOP (TO BE REMOVED)	162.59
5	4000	ENCLOSED HANGAR (6 UNITS) (TO BE REMOVED)	162.43
6	4200	TERMINAL BUILDING	160.88
7	4000	ELECTRICAL VAULT (15'x10')	161.51
8	3600	ENCLOSED HANGAR (10 UNITS)	164.07
9	3000	ENCLOSED HANGAR (10 UNITS)	163.40
10	3200	SHADE HANGAR (10 UNITS)	163.12
11	3400	ENCLOSED HANGAR (10 UNITS)	163.35
12	2600	ENCLOSED HANGAR (14 UNITS)	160.00
13	TBD	FUTURE T-HANGAR (14 UNITS)	TBD
14	TBD	FUTURE T-HANGAR (14 UNITS)	TBD
15	TBD	FUTURE T-HANGAR (10 UNITS)	TBD
16	TBD	FUTURE T-HANGAR (10 UNITS)	TBD
17	TBD	FUTURE T-HANGAR (10 UNITS)	TBD
18	TBD	FUTURE ELECTRICAL VAULT	TBD
19	TBD	FUTURE TERMINAL EXPANSION	TBD
20	TBD	FUTURE HANGAR (120'x120')	TBD
21	TBD	FUTURE HANGAR (150'x100')	TBD
22	TBD	FUTURE HANGAR (100'x100')	TBD
23	TBD	FUTURE HANGAR (5 UNITS)	TBD
24	TBD	FUTURE AIRPORT MAINTENANCE FACILITY (75'x40')	TBD

LEGEND		
ITEM	EXISTING	FUTURE
AIRPORT PROPERTY LINE	---	N/A
AIRFIELD PAVEMENT	▬	▬
BUILDINGS	■	■
ROADS & PARKING	▬	▬
FENCE	x-x-x	xx-xx-xx
RUNWAY SAFETY AREA	—RSA	—(RSA)
RUNWAY OBJECT FREE AREA	—ROFA	—(ROFA)
TAXIWAY OBJECT FREE AREA	N/A	—(TOFA)
OBSTACLE FREE ZONE	—OFZ	—(OFZ)
BUILDING RESTRICTION LINE	—BRL	N/A
PAVEMENT TO BE REMOVED	N/A	▨
EXPANSION AREA	N/A	▨
AWOS CRITICAL AREA EASEMENT	N/A	▨
AVIGATION EASEMENT	N/A	▨
PAPI	■	N/A
REIL	■	N/A
THRESHOLD LIGHTS	••••	N/A
WIND CONE	⊥	⊥
AIRPORT REFERENCE POINT (ARP)	●	N/A
AIRPORT CONTROL STATION	⊗	N/A
ROTATING BEACON	⊗	⊗
AWOS	▲	▲

FAA DISCLAIMER

THE CONTENTS OF THIS PLAN DO NOT NECESSARILY REFLECT THE OFFICIAL VIEWS OR POLICY OF THE FAA. ACCEPTANCE OF THESE DOCUMENTS BY THE FAA DOES NOT IN ANY WAY CONSTITUTE A COMMITMENT ON THE PART OF THE UNITED STATES TO PARTICIPATE IN ANY DEVELOPMENT DEPICTED THEREIN NOR DOES IT INDICATE THAT THE PROPOSED DEVELOPMENT IS ENVIRONMENTALLY ACCEPTABLE IN ACCORDANCE WITH APPROPRIATE PUBLIC LAWS.

CONSTRUCTION NOTICE REQUIREMENT

TO PROTECT OPERATIONAL SAFETY AND FUTURE DEVELOPMENT, ALL PROPOSED CONSTRUCTION ON THE AIRPORT MUST BE COORDINATED BY THE AIRPORT OWNER WITH THE FAA AIRPORTS DISTRICT OFFICE PRIOR TO CONSTRUCTION. FAA'S REVIEW TAKES APPROXIMATELY 60 DAYS.

AIRPORT SPONSOR APPROVAL

THIS AIRPORT DRAWING IS APPROVED BY:

(SIGNATURE) _____ DATE: _____

NAME: _____

TITLE: _____

FDOT AVIATION AND SPACEPORTS OFFICE ACCEPTANCE

THIS AIRPORT DRAWING IS APPROVED BY:

(SIGNATURE) _____ DATE: _____

NAME: _____

TITLE: _____

FAA APPROVAL BLOCK

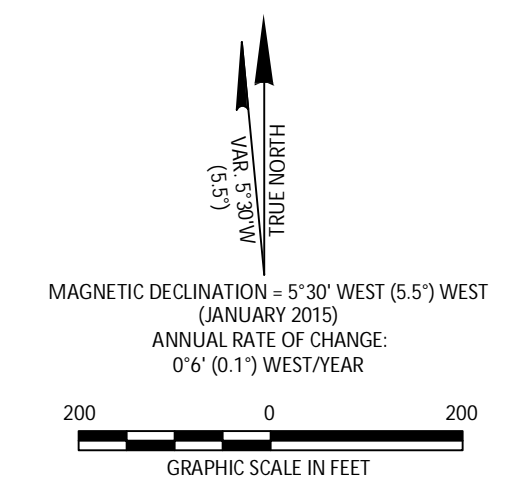

GRAPHIC SCALE IN FEET

200 0 200

DESIGNED: MJK	PROJECT NAME: MASTER PLAN UPDATE PLANT CITY AIRPORT Plant City, Florida	DATE: _____	REVISIONS: _____
DRAWN: RJM	PROJECT NUMBER: _____	DATE: _____	BY: _____
CHECKED: MLT	SHEET TITLE: AIRPORT LAYOUT PLAN DRAWING	DATE: _____	DATE: _____
DATE: AUGUST 2017	HCAA NO.: 6255.14	DATE: _____	DATE: _____
	FDOT NO.: 415760-1	DATE: _____	DATE: _____
	DRAWING NUMBER: 3	DATE: _____	DATE: _____